



9 Sealands Drive, Mumbles, Swansea, SA3 4JU

£185,000

Just moments away from the picturesque Bracelet Bay, this charming two-bedroom detached bungalow offers breathtaking sea views and overlooks the iconic Mumbles Lighthouse. Perfectly positioned for those seeking a serene coastal retreat, this property is ideal as a second home or an investment opportunity. (CASH BUYERS ONLY - EPC RATING G)

The property benefits from a private driveway with ample parking for two cars, adding convenience and ease to your coastal lifestyle. The low-maintenance garden provides the perfect spot to relax and soak in the sea views.

Located within walking distance to the charming seaside village of Mumbles, you'll have easy access to a vibrant array of shops, bars, and restaurants. The nearby coastal path offers endless opportunities for long, scenic

Entrance

Via a frosted double glazed PVC door into the kitchen/living room.

Porch

Kitchen/Living Room 9'10" x 23'1" (3.014 x 7.039)

Living Room

With a double glazed bay window to the front. Door to inner hall. Doors to bedrooms.

Living Room



Kitchen



Is fitted with a range of base and wall units, running work surface incorporating a one and a half bowl stainless steel sink and drainer unit. Four ring gas hob. Integral oven & grill. Plumbing for washing machine. Space for fridge/freezer.

Kitchen



Kitchen



Bedroom One 9'6" x 7'8" (2.904 x 2.341)



With a double glazed window to the rear boasting breathtaking sea views of Bracelet Bay and Mumbles Lighthouse. Door to built in storage.

Bedroom One



Bedroom One View



Bedroom Two 9'7" x 7'6" (2.946 x 2.304)



With a set of double glazed PVC doors to the rear boasting breathtaking sea views of Bracelet Bay and Mumbles Lighthouse. Door to built in storage.

Bedroom Two



Garden



Inner Hall

With a door to the airing cupboard. Door to the bathroom.

Bathroom 6'8" x 5'6" (2.056 x 1.695)



With a frosted double glazed window to the rear. Bathtub. W/C. Wash hand basin. Tiled walls.

External

You have private driveway parking for two vehicles. To the rear you have a patio seating area offering sea views of Bracelet Bay and Mumbles Lighthouse.

Garden



Aerial



Aerial



Aerial



Services

Mains electric. Mains sewerage. Mains water. Mains Gas. Broadband type - ultrafast fibre. Mobile phone coverage available with EE & Vodafone.

Council Tax Band

Tenure

Floor Plan

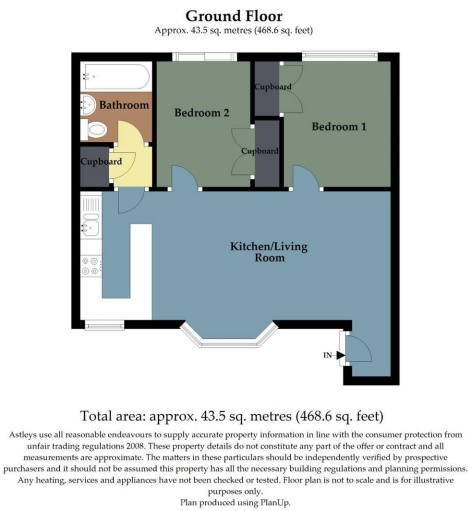

Area Map



Energy Efficiency Graph

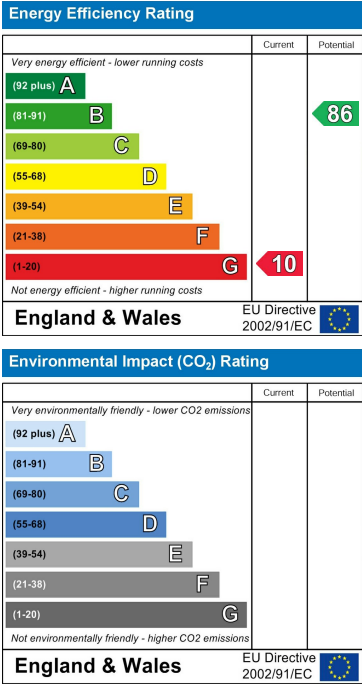

These particulars, whilst believed to be accurate are set out as a general outline only for guidance and do not constitute any part of an offer or contract. Intending purchasers should not rely on them as statements of representation of fact, but must satisfy themselves by inspection or otherwise as to their accuracy. No person in this firms employment has the authority to make or give any representation or warranty in respect of the property.